

## Mechanical Measuring Instruments

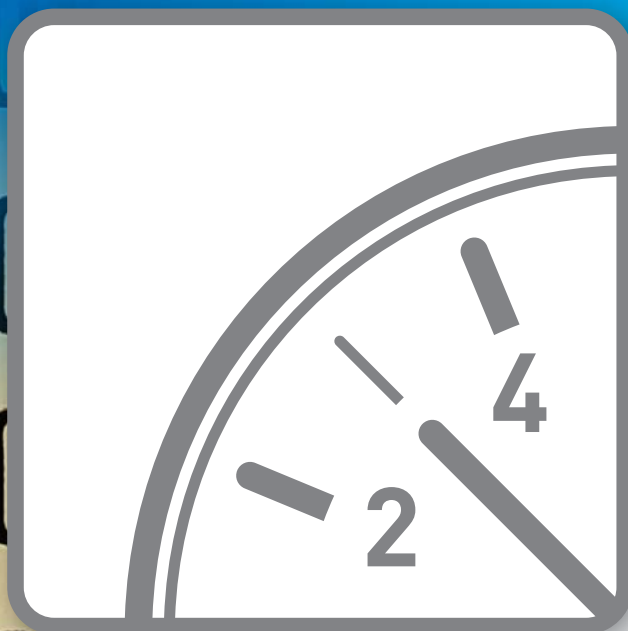

- SIKA thermometers for industry and marine sector
- Special versions and accessories
- SIKA thermometers for heating, air conditioning and ventilation (HVAC)



INDUSTRIAL THERMOMETERS →

## Our range

Mechanical parts as well as glass inserts of our standard types are produced in automated manufacturing processes. However, the glass inserts of special versions, e. g. high temperature versions are still produced by our glassblowers in traditional handcraft. Thanks to our long-year experience, we are in the position to produce custom versions on request. You can obtain popular types from us off the shelf or within a few days.

On the following pages you will find an overview of our extensive range of industrial thermometers. The range in this catalogue includes more than 17 000 different models. In addition, there is a multitude of customer-specific special designs that are used throughout the world.



## Industrial thermometers type B with male thread (nominal size 110)

<b>Order example</b>	<b>174</b>	<b>2</b>	<b>35</b>	<b>1</b>	<b>1</b>	<b>063</b>	<b>2</b>	<b>1</b>
<b>Thermometer type</b>								
Straight	174							
Angle 90°	175							
Angle 135°	176							
<b>Immersion tube type</b>								
Type B		2						
<b>Display ranges</b>								
-30...50 °C			35					
0...60 °C			06					
0...100 °C			10					
0...120 °C			12					
0...160 °C			16					
0...200 °C			20					
<b>Scale</b>								
Celsius °C				1				
Celsius and Fahrenheit (°C + °F)				2				
<b>Filling</b>								
Standard blue fluid for ranges up to 250 °C    Fü =1					1			
<b>Immersion tube length (l<sub>1</sub>)</b>								
30 mm						030		
40 mm						040		
63 mm						063		
100 mm						100		
160 mm						160		
250 mm						250		
<b>Connection thread</b>								
G <sup>3</sup> / <sub>8</sub> / SW22							1	
G <sup>1</sup> / <sub>2</sub> / SW27							2	
M16 x 1.5 / SW22							5	
M20 x 1.5 / SW27							7	
<b>Immersion tube material</b>								
Brass								1
Steel								2
Stainless Steel								3
Special brass								4
Copper-nickel alloy								5

If required please ask for our specification sheet „Immersion tube material“.

# DIN 16181 B, B1 and DIN 16182 S, S1

**Type 174 B**



**Type 175 B**

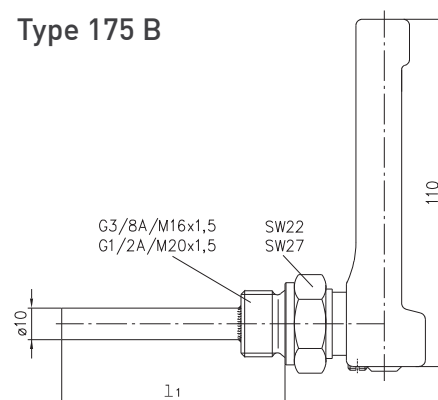

**Type 176 B**

